



creeya  
CREATE YOUR OWN

iNSTA  
Worldwide Group

"Your Partner for Powerful Point of Contact Solutions Worldwide"



Creeya is your answer to make creative and easy to install designs for a wide variety of display and trade show applications.

Creeya is a light weight tool free exhibit system that has standard modules which can be connected together to create various design configurations. This caters to stands from 9 m<sup>2</sup> upto 100m<sup>2</sup> with fabric substrate for graphics. Creeya helps create spaces that make your brand shine brighter.

*With Creeya you can truly create your own!*

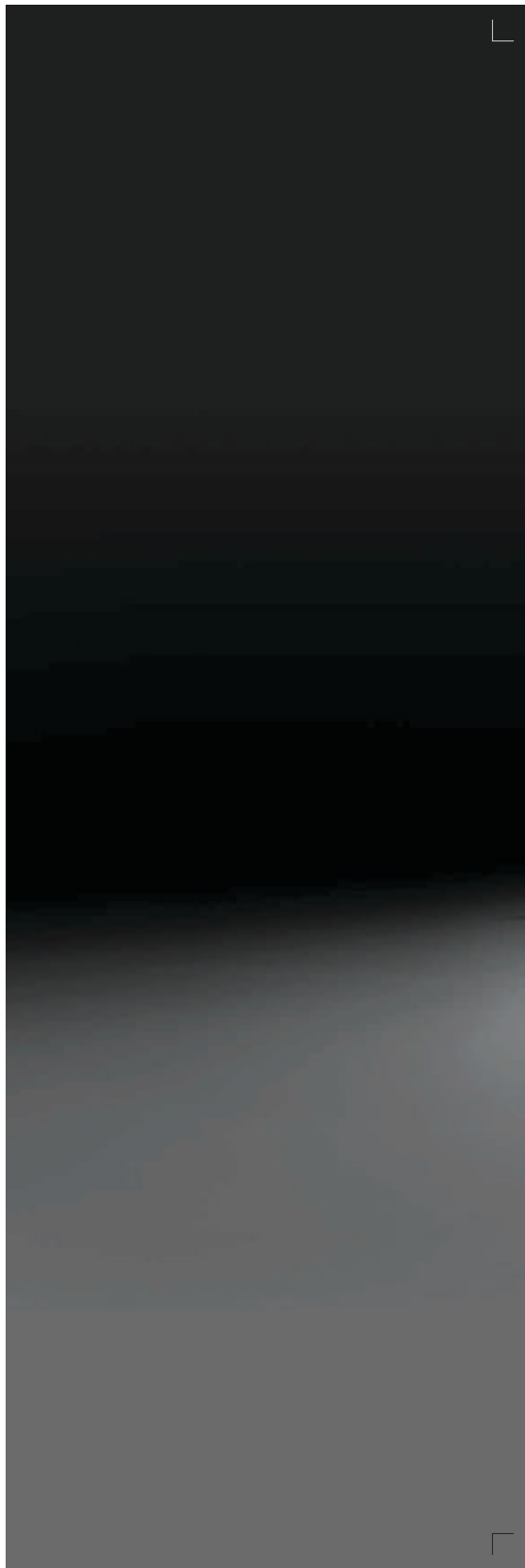



## CREEYA FEATURES

### Structure

The uniquely engineered profiles allow use of different graphic media such as fabric, PVC Board and even wooden panels. Creeya offers a light weight tool-free set-up for numerous display and trade show applications. The combination of standard modules provides custom look and feel to your exhibit. A selection of structural attachments are available to add stability and style to your booth design.

### Lighting

Creeya uses energy efficient LED arm lights for illuminating the booth. These arm lights can be easily assembled with a standard connector onto the Creeya module and tilt adjusted to focus on specific parts of the booth.

### Accessories

The Creeya system offers a platter of accessories to add to the utility of the exhibit display depending on the type of event or industry you represent. These include the product shelves of different shapes and sizes, promotional counter, screen mounting attachment and headers to name a few.



Quick Set-up



Modular



Tool Free



LED



Stable

## CREEYA FEATURES

### Graphic

Creeya's fabric graphic features a silicon edge bead to ease installation. The beaded graphic can be easily inserted and pressed into a groove in the system to get the exhibit set up in no time!

### Packaging

A Creeya design has two options for packaging. Smaller booths pack in a plastic shipping case that accommodates the complete structure including graphics and lighting. For larger booths flight cases are offered to flat pack the complete stand. Both the cases can be shipped to the fairground using a standard shipper.

### Application

The Creeya solution can be used for trade shows for building a wide range of custom - modular booths. It offers a possibility of adding pantries and conference rooms for predetermined appointments. Creeya also offers display solutions for POP applications and brand activation events such as product launches, conference, promotions and road shows.



Light Weight



Easy to Transport



DIY



Double Sided Graphic



Eco-Friendly Fabric Graphics

## CREEYA MODULAR EXHIBITS (9m<sup>2</sup> - 18m<sup>2</sup>)

Creeya two side open booth

Two headers provide top branding

One open meeting area

One lockable counter



Creeya one side open booth

One open meeting area

One reception counter

Unique wings at the entrance

Backwall with an LCD Display

creeya  
CREATE YOUR OWN

## CREEYA MODULAR EXHIBITS (9m<sup>2</sup> - 18m<sup>2</sup>)

Creeya two side open booth

One pantry with a curtain

One open meeting area

Big screen along the aisle to  
attract traffic

Roof bridges enhance looks  
and stability

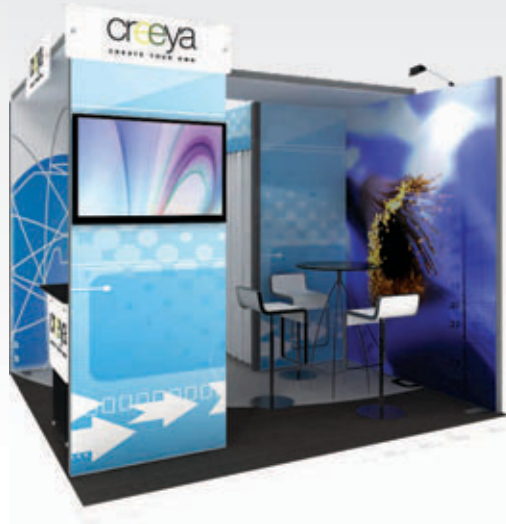

Creeya two side open booth

One open discussion area

Two digital demo station at the  
entrance

Uniquely shaped wings at the  
corners

**creeya**  
CREATE YOUR OWN



## CREEYA MODULAR EXHIBITS (9m<sup>2</sup> - 18m<sup>2</sup>)



18m<sup>2</sup> two side open booth

One lockable reception counter

Two headers for high branding

One open discussion area

Lockable backwall counters

Roof bridge to provide structure

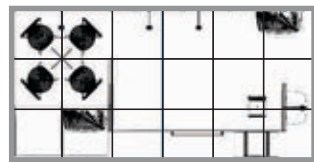



## CREEYA MODULAR EXHIBITS (9m<sup>2</sup> - 18m<sup>2</sup>)



15m<sup>2</sup> two side open booth

One info screen along the aisle

Two top headers

One open discussion area

One lockable reception counter with storage

Two Creeya promotion counters to stack brochures

Two bridge roofs for structural integration

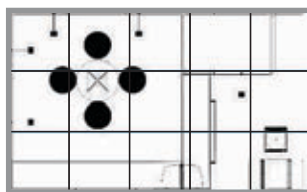

**creeya**  
CREATE YOUR OWN

## CREEYA MODULAR EXHIBITS (18m<sup>2</sup> - 30m<sup>2</sup>)



24m<sup>2</sup> one side open booth

One pantry and one meeting room with curtain

One open discussion area

One lockable reception counter

Fascia frame bridge for top branding

Unique wings to add a creative entrance

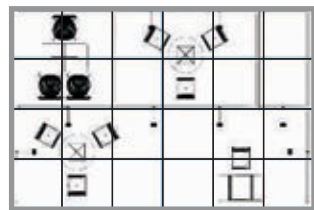

## CREEYA MODULAR EXHIBITS (18m<sup>2</sup> - 30m<sup>2</sup>)



18m<sup>2</sup> one side open booth

Two headers for top branding

One closed conference room

One overlay panel for additional branding

One closed pantry for extra storage

One square reception shelf

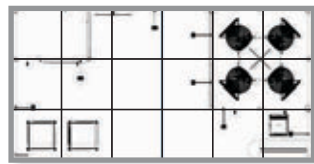

## CREEYA MODULAR EXHIBITS (18m<sup>2</sup> - 30m<sup>2</sup>)



Two entrances from the aisle

Two back wall counters for storage

One reception area with backdrop display

Unique booth structure that allows easy traffic  
and additional storage area



## CREEYA MODULAR EXHIBITS (18m<sup>2</sup> - 30m<sup>2</sup>)



One reception counter

Two headers for top branding

Two open discussion area

One closed pantry for extra storage

Unique wings to add a creative entrance

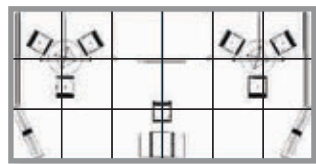

## CREEYA MODULAR EXHIBITS (36m<sup>2</sup> and Beyond)



Central storage tower for concealed storage

One reception counter with storage

Set of six product shelves

One open discussion areas

Four information kiosks along the aisle

Connecting roof bridges for structural integration

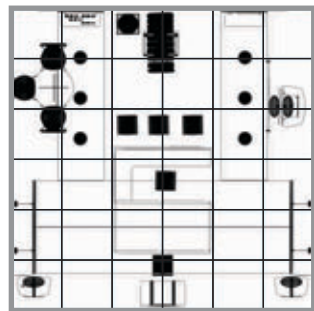

## CREEYA MODULAR EXHIBITS (36m<sup>2</sup> and Beyond)



Backwall with integrated storage tower

Four workstations integrated with the walls

Three open discussion areas

Front fascia for attractive high branding

Roof bridge to provide integrated structure

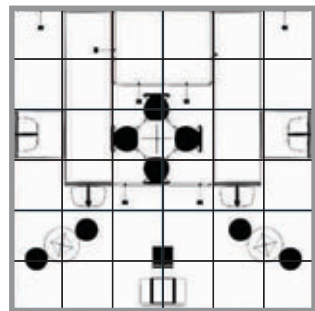

creeya  
CREATE YOUR OWN



## CREEYA MODULAR EXHIBITS (36m<sup>2</sup> and Beyond)



Two side open corner booth

One Reception counter along the aisle

Two open discussion areas

One closed meeting room and one pantry

Central bridge with LCD screen for interactive display

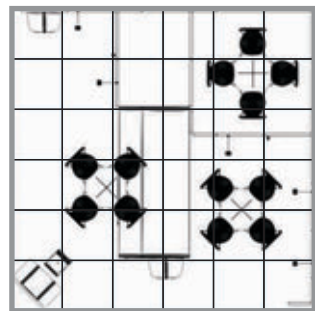

## CREEYA MODULAR EXHIBITS (36m<sup>2</sup> and Beyond)



Four entry points in the booth

One reception counter with storage

One central storage tower at the rear

Two open discussion areas

Set of three promotion counters with lcd screen mounting

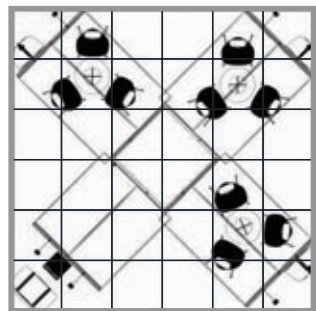

## CREEYA MODULAR EXHIBITS (36m<sup>2</sup> and Beyond)



Bridge made out of Creeya fascia for top branding

Workstation counter for an interactive presentation

Creeya reception and backwall counters for additional storage

Open discussion area for short meetings

Overlay panel for Creeya counter add more branding space

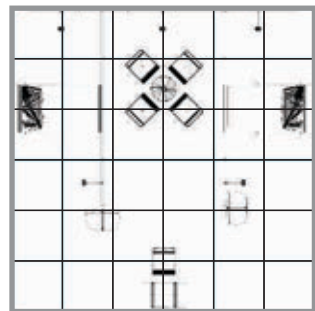

creeya  
CREATE YOUR OWN

## CREEYA MODULAR EXHIBITS (36m<sup>2</sup> and Beyond)



Central Lockable pantry

unique shaped brand colored wings

Connected structures

Two 32" screens for interactive presentations

Two open discussion area

Ample space for visitor movement

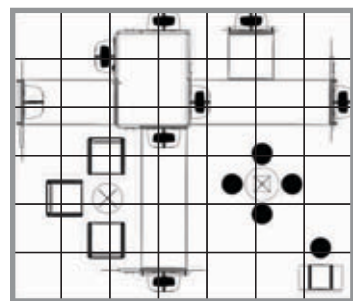

## CREEYA : ONE KIT MULTIPLE SOLUTION

With Creeya solution you can create different configurations with the same hardware for various booths. This enables the user to reconfigure it for a calendar of events maximizing your ROI.



36 m<sup>2</sup> two side open booth

Two Top fascia for high branding

One reception counter along the aisle

Vertical flap walls add a design touch

One open discussion room

One closed meeting room

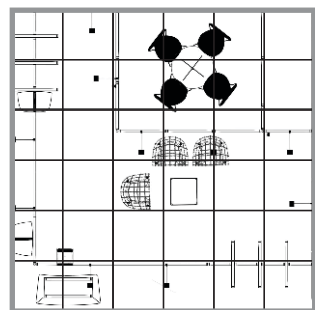

creeya  
CREATE YOUR OWN

## CREEYA : ONE KIT MULTIPLE SOLUTION



3 x 3  
Two Side Open Booth



6 x 3  
Two Side Open Booth

## ACCESSORIES

### Wings

Wings add more aesthetic appeal to the Creeya exhibit. The Wings have an option of frosted acrylic or printed PVC boards. Wings add a creative edge to the exhibit and pack in a fabric bag.

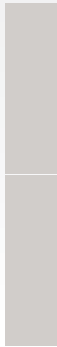

Rectangular



Triangular

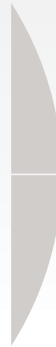

Sail

---

### Overlay Panels

Creeya helps promote your brand loud and clear with a menu of Overlay panel options. These can be printed upon and also add an aesthetic appeal to the booth.



Inclined



Flame



Rectangular



## ACCESSORIES

### Header

Header is a standard accessory offered with the Creeya exhibit. It has three types of headers namely the rectangular, Oval and wave header. Each one of these can be used for high branding and to accentuate your messaging. The header has an option of frosted acrylic or printed PVC board.



Rectangle Header



Oval Header



Wave Header

### Product Shelving

The product shelving option on Creeya is available in five types namely Full Shelf, Mini Shelf, Round, Small Oval and Big Oval. These are made of black laminated MDF and attach to the Creeya frame with unique connectors. This enables you to mount the shelves at the center of the Creeya Module as well as on the sides. The product shelves are designed to take a load upto 10 Kg\*.



Full Shelf



Mini Shelf



Round



Small Oval



Big Oval

\* Wall structure design should be stable

## ACCESSORIES

### Counters (SNAP)

#### Promotion Counter

Creeya Promotion Counter is a stable counter that uses the Creeya Fascia module for branding and wooden table top. The counter attaches to the Creeya structure with a Frank Junction Post. An overlay panel can also be added to the promotion counter for added branding. Snap packs in a fabric bag.



#### Reception Counter (RAPID PLUS)

Creeya Reception Counter has a contemporary laminated MDF front and back panel with fabric sides. The counter has an acrylic fascia attached to the front panel that provides more branding space. The back panel has a lockable door to keep the content secure. The weight carrying capacity of the counter is 40 Kg. The counter has one shelf made of laminated plywood and packs in a riveted shipping case.

### Lighting

Creeya offers eco friendly LED arm lights to illuminate the exhibit and the entire booth. These arm lights have a connector that helps connect to a Creeya module with ease.



### Screen Mounting Attachment

Creeya screen mounting involves mounting an LCD bracket with knobs to a Creeya Mid Height Roof Post. To this an LCD screen upto 22" is easily slid on & connected.



## ACCESSORIES

### Door

The privacy required for conference rooms and pantry at an exhibition booth is provided by the Creeya door. It uses fabric graphics which add on the branding space in the booth. The fabric door too has a complete tool free assembly.



### Mid Height Roof Post

Creeya comes with a Mid Height Roof Post to mount LCD screen or product shelves. The same post can also be used to form Mid Height Roofs / Bridges connected to a Creeya wall.

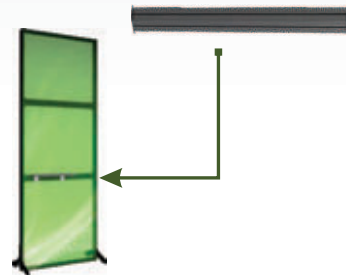

### Packaging Case

Creeya backwalls pack in an easy to carry riveted shipping case while booths pack in flight cases. Booth packaging options are available depending on the booth design and size.



Riveted Case  
W 550mm x H 160mm x L 1215mm



Flight Case  
W 415mm x H 365mm x L 1250mm

## OUR GLOBAL PRESENCE



### INDIA

Insta Exhibitions (P) Ltd.  
B-602 Pramukh Plaza, Cardinal Gracious Rd. Chakala,  
Andheri (E), Mumbai, 400099, INDIA  
Tel: +91 22 40649200 / 2825 1806 Fax: +91 22 2825 1836  
Email: enquiry@insta-group.com



an Insta Worldwide Group Company



### UAE

E.D.S Middle East LLC  
Office No. 203, Crystal Tower, Burj Khalifa Area,  
Business Bay, Dubai Tel.: +971 4 4227053 / +971 4 4232020  
Fax.: +971 4 4232008 Email: info.dubai@insta-group.com



### USA

Exponents  
INSTA USA INC.  
1351, AIR WING Road, Suite # 2  
San Diego, CA. 92154 Tel: +1 619 298 6473 Ext. 110  
Fax: +1 619 374 2797 Email: info@exponents.com



### CANADA

Exponents  
6201 Highway 7, #11 Vaughan, ON L4H 0K7  
Tel: +1 (855) 333-EXPO Fax: +1 (416) 309-2036  
Email: info@exponents.ca



an Insta Worldwide Group Company



#### **GERMANY**

Expo Display Service GmbH  
Katharina-Paulus-Strasse 6 E-F, Camp Phoenix Park  
D-65824 Schwalbach am Taunus Tel: +49 [0] 61 96 - 96 75 - 0  
Fax: +49 [0] 61 96 - 96 75 - 196 Email: [info@expodisplayservice.de](mailto:info@expodisplayservice.de)



#### **BELGIUM**

Expo Display Service  
Draaiboomstraat 6/9, BE-2160 Wommelgem  
Tel : +32 (3) 385 21 96 Fax : +32 (3) 385 21 97  
Email : [info@expodisplayservice.be](mailto:info@expodisplayservice.be)



#### **FRANCE**

Expo Display Service  
Bureau commercial Lyon, Immeuble Plaza, 93,  
rue de la Villette, FR-69003 Lyon  
Tel. +33 (0)4 20 10 24 88 Fax +33 (0)4 20 10 25 00  
Email: [info@expodisplayservice.fr](mailto:info@expodisplayservice.fr)



#### **AUSTRIA**

Expo Display Service Hd.GmbH  
FLORIDOTOWER, Floridsdorfer Hauptstraße 1,  
AT-1210 Wien Tel : +43 (0)1 270 60 50  
Fax : +43 (0)1 270 60 50 40  
Email : [info@at.expodisplayservice.at](mailto:info@at.expodisplayservice.at)



#### **NETHERLANDS**

Expo Display Service B.V  
Jean Monnetpark 31, NL-7336 BA Apeldoorn  
Tel : +31(0)55 32 385 55 Fax : 055 323 1999  
Email : [info@expodisplayservice.nl](mailto:info@expodisplayservice.nl)



#### **SPAIN**

Expo Display Service S.A  
C/Esteve Terradas 51-55, ES-08023 Barcelona  
Tel: +34 (93) 434 03 03  
Fax: +34 (93) 417 78 67  
Email: [expods@terra.es](mailto:expods@terra.es)



#### **SWITZERLAND**

Expo Display Service AG  
Hauptsitz Müllerenstrasse 3CH-8604 Volketswil  
Tel. +41 (0)52 396 53 53  
Fax +41 (0)52 396 53 99  
Email : [info@expodisplayservice.ch](mailto:info@expodisplayservice.ch)

## OFFICES IN INDIA



### MUMBAI (HEAD OFFICE)

Insta Exhibitions (P) Ltd.  
B-602 Pramukh Plaza, Cardinal Gracious Rd. Chakala, Andheri (E),  
Mumbai - 400099, INDIA Tel: +91 22 40649200 / 2825 1806  
Fax: +91 22 2825 1836 Email: enquiry@insta-group.com

### DELHI

Insta Exhibitions (P) Ltd.  
Plot No. 373, Sector - 37, Pace City - II, Gurgaon - 122001, INDIA  
Tel: +91-124-4758900 Fax: +91-124-2210746  
Email: enquiry@insta-group.com

### AHMEDABAD

Insta Exhibitions (P) Ltd.  
103, ARTH Complex, Nr Meethakali Circle, Navrangpura,  
Ahmedabad - 380009, INDIA Tel: +91-79-26442390 Fax: +91-26442396  
Email: enquiry@insta-group.com

### SECUNDERABAD

Insta Exhibitions (P) Ltd.  
312, Mittal Chambers, 3rd Floor, M.G. Road,  
Secunderabad - 500003, INDIA Tel: +91-40-66333129  
Fax: +91-40-66333128 Email: enquiry@insta-group.com

### CHENNAI

Insta Exhibitions (P) Ltd.  
No. 42 Montieth Road, No. 04, 4th Floor, Sindhur Plaza,  
Egmore, Chennai - 600008, INDIA Tel: +91-44-42148543/65244978  
Fax: +91-44-42148543 Email: enquiry@insta-group.com

### BANGALORE

Insta Exhibitions (P) Ltd.  
No. 313, Insta House, 15th Cross, JP Nagar, 5th Phase, 100 Ft. Road  
Ring Road, Bangalore - 560078, INDIA Tel: +91-80-41404100/41132178  
Fax: +91-80-41517717 Email: enquiry@insta-group.com

### PUNE

Insta Exhibitions (P) Ltd.  
Lloyds Chambers, Block - III, Office No: 309/310  
Mangalwar Peth, Pune - 411011 Tel: +91-020-41209410  
Email: enquiry@insta-group.com

Follow us on



[www.creeya.com](http://www.creeya.com)

Version 1 (CR-IN.) May 2013